

Direction of  
Steel Deck Flutes

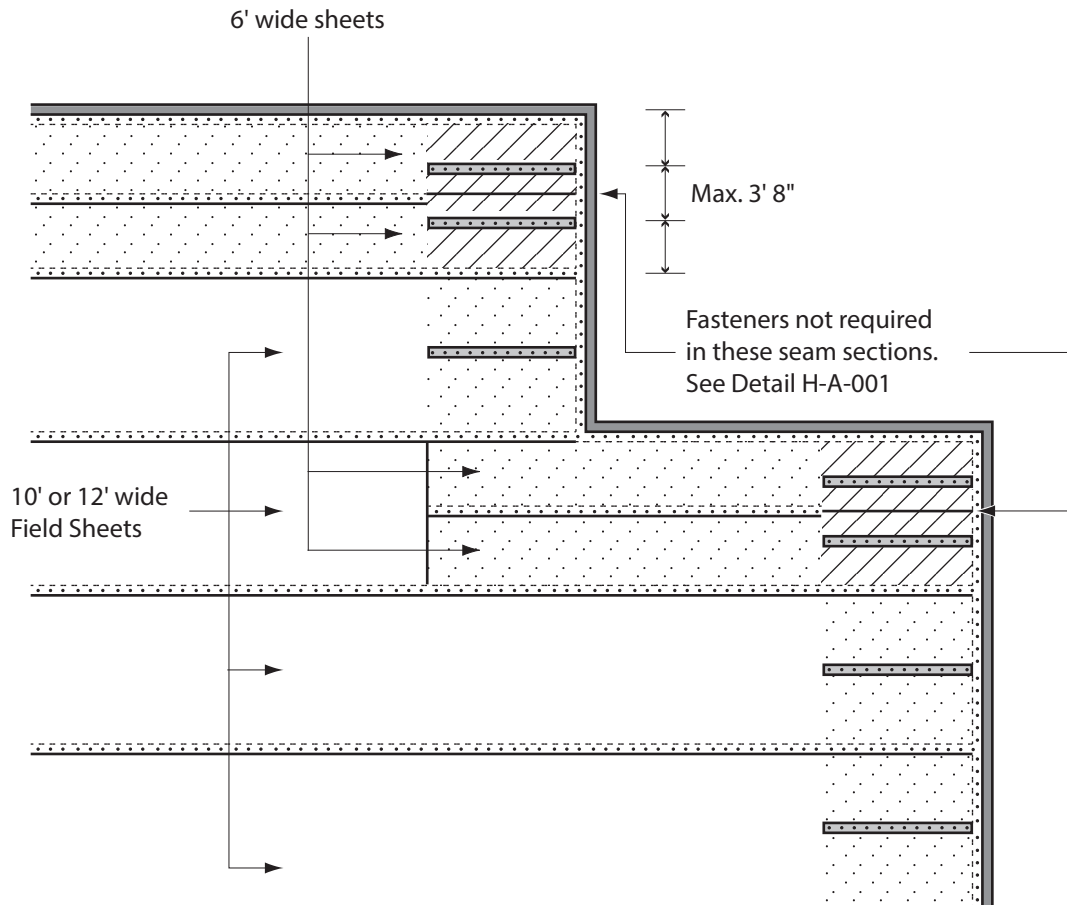

EXAMPLE



Notes:

FM defined Perimeter Area †

FM defined Corner Area

Fastening within Field Seam (Detail H-E-011)

Fastening under Reinforced Strip\* or P.S. Coverstrip †

— Field Sheet Seam without fasteners (Detail H-A-001)

\*: Heat welded on all sides †: Applied with Primer.

‡: The lesser of 0.1 times the building's lesser plan dimension or 0.4 times the eave height, subject to a minimum width of 4' (1.2m).



**FM Fastening using 10' or 12' Hi-Tuff TPO Field Sheets**  
**Alternative 2: Single Direction Rows**  
**Roofing System Detail**

Scale: Not to scale

Date: August, 2016

Detail No.: H-E-016